

Grundfos SL1

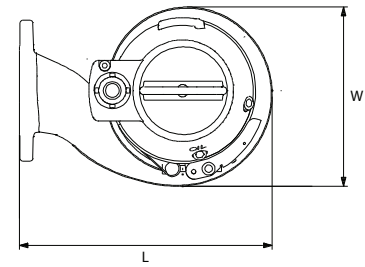

- Cast iron submersible sewage pump
- Designed to handle unscreened sewage
- Suitable for commercial waste water, flood control, industrial waste water treatment/reuse and waster water transfer
- Maximum particle size 50mm
- 10m power cable

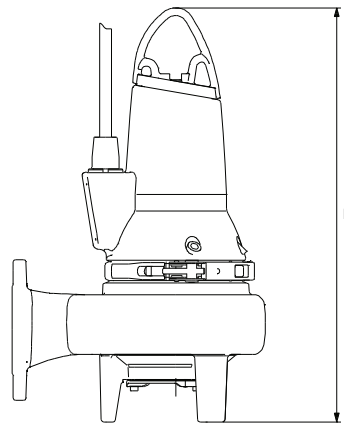
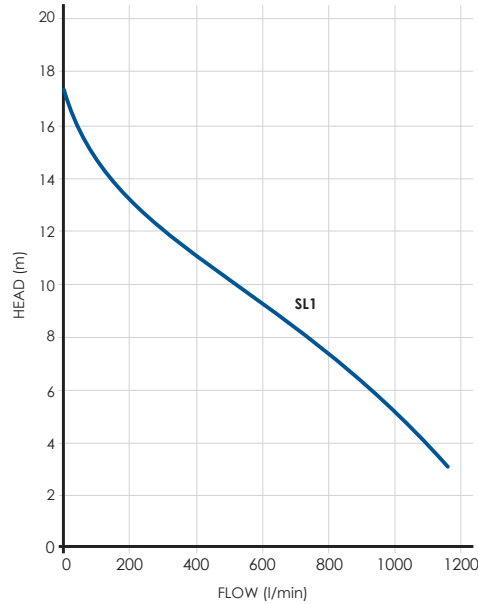

PERFORMANCE GUIDE

Code	Max Head (m)	Rated Flow (l/min)	Max Pressure (psi)	Max Solid (mm)	Inlet (mm)	Outlet (mm)
PUGRUSL1.50.65.EX.15.2.50B	17	1170	24	50	65	65

ELECTRICAL DATA

Code	Current Type	kW	Hp	Amps	RPM/min	Insulation Class	Voltage (V)	Frequency (Hz)
PUGRUSL1.50.65.EX.15.2.50B	Three	1.5	2	3.8	2720	F	400	50

DIMENSIONS

Code	H (mm)	L (mm)	W (mm)	Weight (kg)
PUGRUSL1.50.65.EX.15.2.50B	544	333	242	53.7

